

Green Pin® plate lifting clamp, type E for lifting and vertical transportation

- **Material** : carbon and alloy steel
- **Safety factor** : MBL equals 5 x WLL
- **Finish** : painted green
- **Certification** : manufacturer's certificate including serial number
test certificates can be supplied upon request

P-6615

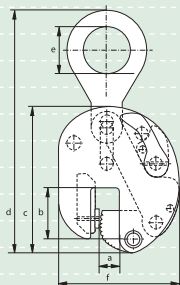

type	working load limit tons	width opening		length opening		length d mm	diameter inside eye e mm	width f mm	thickness g mm	weight per pce kg
		a mm	b mm	c mm	d mm					
0.75 E	0.75	0 - 14	45	115	210	30	104	36	1.5	
1 E	1	0 - 22	72	200	337	57	170	44	6	
1.5 E	1.5	0 - 22	72	200	337	57	170	52	7.1	
2 E	2	0 - 28	87	237	430	70	218	65	13.2	
3 E	3	0 - 28	87	237	430	70	218	77	14.2	
4 E	4	0 - 32	115	293	500	86	226	69	21	
6 E	6	0 - 32	115	293	500	86	226	85	24.2	
7.5 E	7.5	0 - 42	120	350	560	80	305	90	35	
9 E	9	0 - 52	125	380	620	88	274	90	48	
12 E	12	0 - 75	135	480	760	90	410	130	90	
15 E	15	0 - 75	135	480	760	90	410	130	90	
20 E	20	0 - 75	160	550	890	100	490	140	132	

Green Pin® plate lifting clamp, type ES for lifting and vertical transportation

- **Material** : carbon and alloy steel
- **Safety factor** : MBL equals 5 x WLL
- **Finish** : painted green
- **Certification** : manufacturer's certificate including serial number
test certificates can be supplied upon request

P-6616

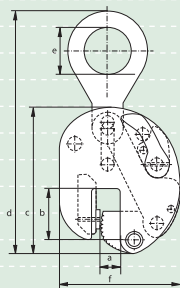

type	working load limit tons	width opening		length opening		length d mm	diameter inside eye e mm	width f mm	thickness g mm	weight per pce kg
		a mm	b mm	c mm	d mm					
0.75 ES	0.75	12 - 24	45	115	210	30	114	36	1.5	
1 ES	1	18 - 38	72	200	337	57	186	44	6	
1.5 ES	1.5	18 - 38	72	200	337	57	186	52	7.1	
2 ES	2	23 - 50	87	237	430	70	240	65	13.2	
3 ES	3	23 - 50	87	237	430	70	240	77	14.2	
4 ES	4	26 - 58	115	293	500	86	252	69	21	
6 ES	6	26 - 58	115	293	500	86	252	85	24.2	
7.5 ES	7.5	30 - 72	120	350	560	80	335	90	35	
9 ES	9	48 - 100	125	380	620	88	274	90	48	
12 ES	12	75 - 150	135	480	760	90	485	130	90	
15 ES	15	75 - 150	135	480	760	90	485	130	94	
20 ES	20	75 - 150	160	550	890	100	565	140	132	



P-6625

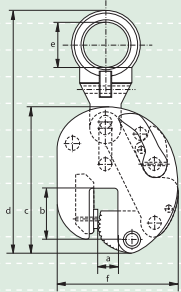

Green Pin® plate lifting clamp, type EU for lifting and transportation in all directions

- **Material** : carbon and alloy steel
- **Safety factor** : MBL equals 5 x WLL
- **Finish** : painted green
- **Certification** : manufacturer's certificate including serial number
test certificates can be supplied upon request

type	working load limit	width opening	length opening	length	length	diameter inside eye	width	thickness	weight per pce
0.75 EU	0.75	0 - 14	45	115	220	31	104	36	1.6
1.5 EU	1.5	0 - 22	72	200	327	68	170	52	7.9
3 EU	3	0 - 28	87	237	450	80	218	77	15.2
6 EU	6	0 - 32	115	293	480	80	226	85	26
7.5 EU	7.5	0 - 42	120	350	580	80	305	90	35
9 EU	9	0 - 52	125	380	700	90	274	90	52
12 EU	12	0 - 75	135	480	780	115	410	130	94



P-6626

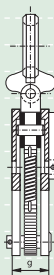
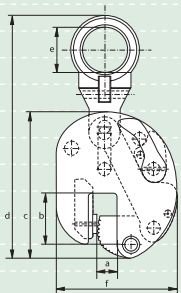

Green Pin® plate lifting clamp, type EUS for lifting and transportation in all directions

- **Material** : carbon and alloy steel
- **Safety factor** : MBL equals 5 x WLL
- **Finish** : painted green
- **Certification** : manufacturer's certificate including serial number
test certificates can be supplied upon request

type	working load limit	width opening	length opening	length	length	diameter inside eye	width	thickness	weight per pce
0.75 EUS	0.75	12 - 24	45	115	220	31	114	36	1.6
1.5 EUS	1.50	18 - 38	72	200	327	68	186	52	7.9
3 EUS	3	23 - 50	87	237	430	80	240	78	15
6 EUS	6	26 - 58	115	293	480	80	252	95	26
7.5 EUS	7.5	30 - 72	120	350	580	80	335	100	35
9 EUS	9	48 - 100	125	380	700	90	384	100	52
12 EUS	12	75 - 150	135	480	780	115	485	140	94

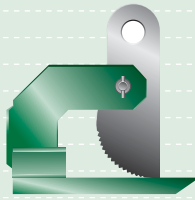

P-6635

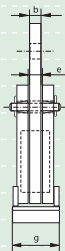
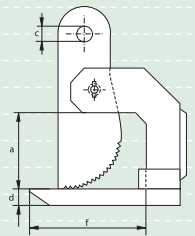

Green Pin® plate lifting clamp, type EH for lifting and horizontal transportation

- **Material** : carbon and alloy steel
- **Safety factor** : MBL equals 5 x WLL
- **Finish** : painted green
- **Certification** : manufacturer's certificate including serial number
test certificates can be supplied upon request

type	working load limit per set	width opening		thickness	diameter eye	thickness	width	length	width	weight per set
		a mm	b mm	c mm	d mm	e mm	f mm	g mm	kg	
1.5 EH	1.5	0 - 22	18	16.2	12	16	70	60	4	
3 EH	3	0 - 60	16	23	25	18	155	80	11	
4 EH	4	0 - 60	20	42	25	22	155	80	16.4	
6 EH	6	0 - 60	20	42	25	22	155	100	17.8	
8 EH	8	0 - 60	25	42	25	27	155	120	20	
10 EH	10	0 - 60	25	42	30	27	155	120	28	
14 EH	14	0 - 60	30	48	35	32	155	130	36	
18 EH	18	0 - 60	30	48	40	32	155	150	48.2	

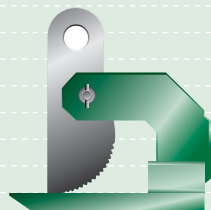

P-6636

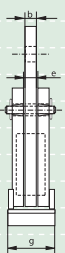
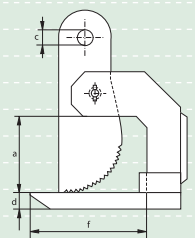

Green Pin® plate lifting clamp, type EHS for lifting and horizontal transportation

- **Material** : carbon and alloy steel
- **Safety factor** : MBL equals 5 x WLL
- **Finish** : painted green
- **Certification** : manufacturer's certificate including serial number
test certificates can be supplied upon request

type	working load limit per set	width opening		thickness	diameter eye	thickness	width	length	width	weight per set
		a mm	b mm	c mm	d mm	e mm	f mm	g mm	kg	
3 EHS	3	0 - 100	16	23	25	18	155	80	12.4	
4 EHS	4	0 - 100	20	42	25	22	155	80	17.6	
6 EHS	6	0 - 100	20	42	25	22	155	100	20	
8 EHS	8	0 - 100	25	42	25	27	155	120	26	
10 EHS	10	0 - 100	25	42	30	27	155	120	32	
14 EHS	14	0 - 100	30	48	40	32	155	130	40	
18 EHS	18	0 - 100	30	48	40	32	155	150	52	

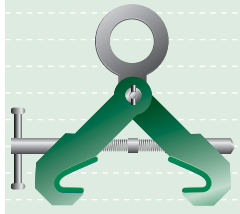

P-6685

Green Pin® lifting clamp, type ESV for lifting and transportation of steel beams

- **Material** : carbon and alloy steel
- **Safety factor** : MBL equals 5 x WLL
- **Finish** : painted green
- **Certification** : manufacturer's certificate including serial number
test certificates can be supplied upon request

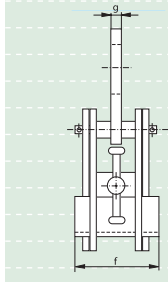
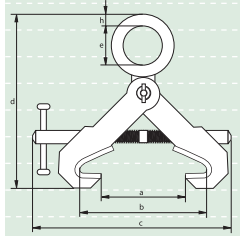

type	working load limit tons	width jaw opening	width jaw opening	length c mm	height d mm	diameter eye inside e mm	width f mm	thickness g mm	width h mm	weight per pce kg
		a mm	b mm							
2 ESV	2	0 - 160	60 - 200	270	210 - 250	65	120	16	22	5.1
3 ESV	3	0 - 160	60 - 200	270	250 - 290	65	120	16	22	5.3
4 ESV	4	0 - 250	80 - 310	400	285 - 370	70	125	20	28	8.6
5 ESV	5	0 - 260	90 - 320	400	355 - 445	80	125	20	36	11.1
6 ESV	6	0 - 340	85 - 420	480	360 - 510	80	125	20	36	14

Green Pin® plate lifting clamp spare parts



P-6651 lifting eye



P-6652 lock lever assembly



S-6653 lock spring



P-6654 cam assembly



S-6655 cam pin



S-6656 pivot



S-6657 eye pin



P-6658 universal eye component

1
2
3
4
5
6
7
8
9
10
11
12
13
14
15
16